

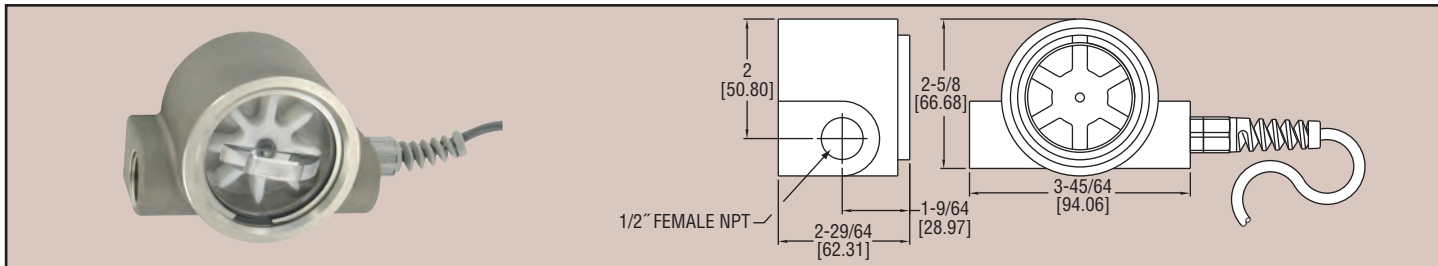

Series
SF

Sight Flow Transmitter

±2% FS Accuracy, 4 to 20 mA Output, Pressure up to 500 psig (34 bar)



Series SF Sight Flow Transmitter integrates tangential turbine technology with hermetically sealed circuitry to provide accurate flow measurement and control in the harshest environments. The 2-wire loop-powered design transmits a 4 to 20 mA signal proportional to flow rate. Models can accurately measure flow in both directions and can be mounted in any orientation. Model SF11 has a clear polycarbonate viewing cover for visible indication of flow. Units feature LED power indication, adjustable zero and span, polarity protection and over current limiting.

Model	Cover Material
SF10	316 SS
SF11	Clear Polycarbonate

APPLICATIONS

Ideal for measuring flow rates in cooling and lubrication circuits, HVAC systems, aggressive chemical metering, and batching systems.

SPECIFICATIONS

Service: Compatible liquids.

Wetted Materials: 316 SS shaft and case, Iglide® bearings, Buna-N seal and acetal copolymer, (polycarbonate cover on Model SF11).

Flow Range: 0.5 to 15 GPM (5.7 to 56.8 LPM).

Accuracy: ±2% FS.

Repeatability: 0.5% full scale.

Temperature Limits: 20 to 225°F (-7 to 107°C).

Pressure Limits: 500 psig (34 bar) Model SF10; 200 psig (14 bar) Model SF11.

Response Time: 2 seconds to 90% (step change in flow rate).

Supply Voltage: 12 to 35 VDC.

Output: 4 to 20 mA.

Loop Resistance: 1150 ohms max.

Process Connection: 1/2" female NPT.

Electrical Connection: Wire leads: 22 AWG x 9' (2.7 m).

Max. Particle Size: 100µm.

Agency Approvals: CE.