

Line equipment  
for special applications

# Pressure Reducer Regulus SST

low flow, low pressure

LAB  
line

## Specifications

### Fluid Media

Non corrosive and corrosive gases up to gas purity 5.0 (99.999 Vol %) which are compatible with the material

### Operation Parameters

Max. rated inlet pressure: . . . . . 8 bar / 116 PSIG

Outlet pressure range:

. . . . . 30 - 120 mbar / 0.9 - 3.5 "Hg

. . . . . 80 - 320 mbar / 2.4 - 9.4 "Hg

. . . . . 200 - 800 mbar / 5.9 - 23.6 "Hg

Nominal flow (l/min): . . . . . 50 - 150

Body: . . . . . Stainless Steel

Diaphragm: . . . . . EPDM

Seat: . . . . . EPDM

Operating temperature: . . . . . -20 to +70 °C

Weight (kg): . . . . . 1.5

Port types and sizes:

Inlet . . . . . G 1/2

Outlet . . . . . G 1/2

Gauge . . . . . G 1/2

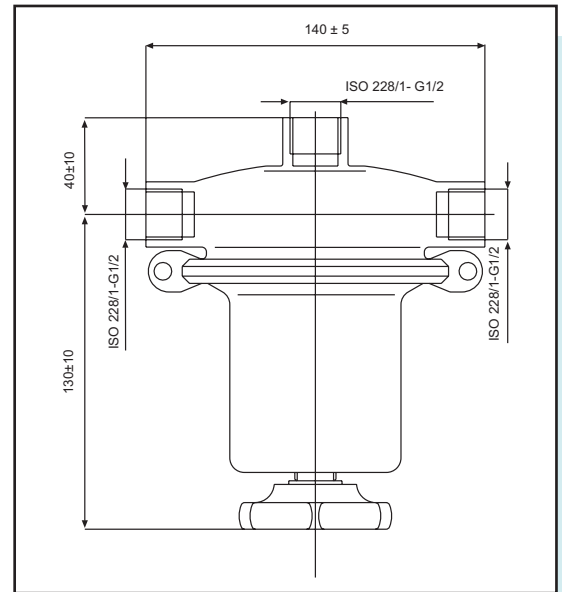

## Advantages

- Regulation in mbar range without external energy
- Accurate and sensible pressure control
- Flow up to 150 l/min
- Positive seal mechanism for leak tight shut-off and stable outlet pressure

## Flow Chart

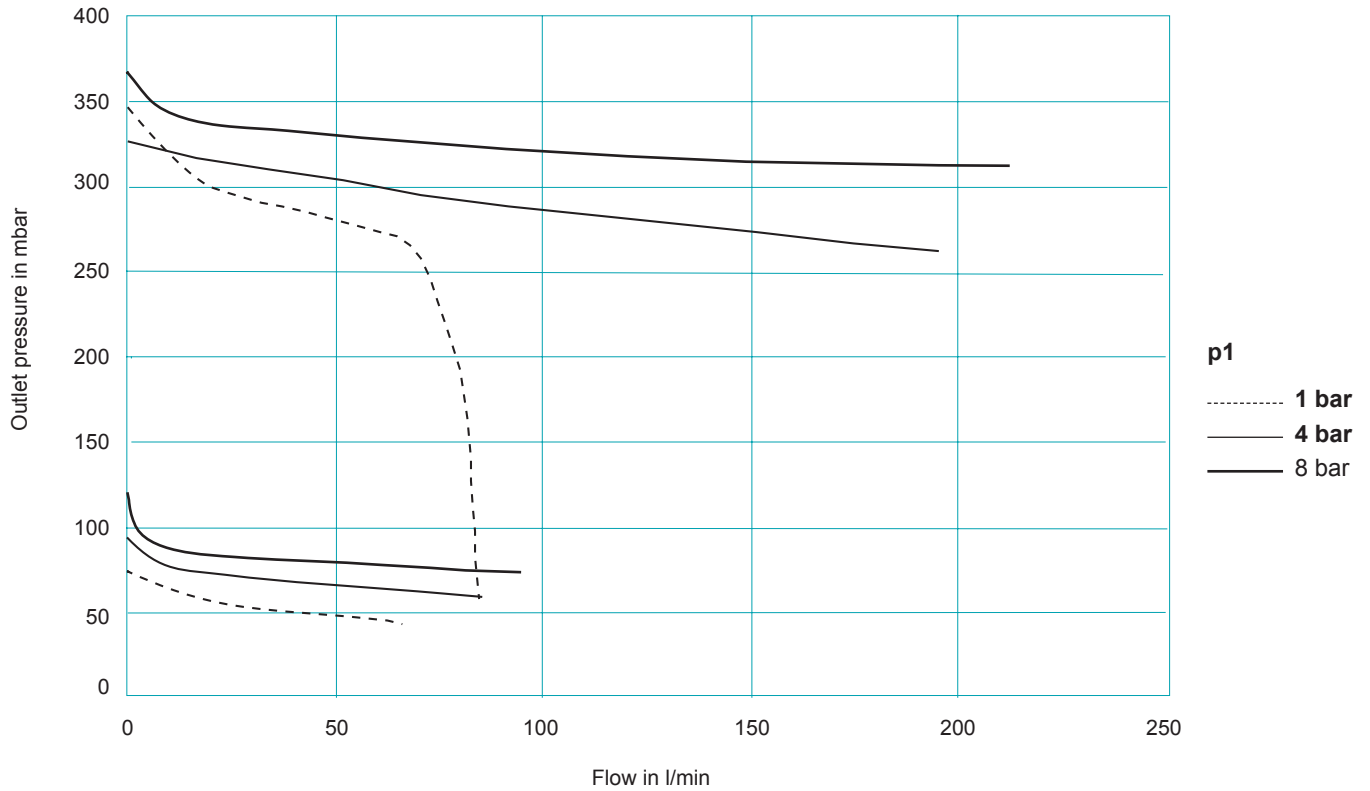

## Ordering Information

OUTLET PRESSURE RANGE	ORDERING NO.
30-120 mbar	D 44595-120
80-320 mbar	D 44595-320
200-800 mbar	D 44595-800